

GroovePatrol II

FM Transmitter & Car Dock

Setup Instructions

Thank you for purchasing Cygnett's GroovePatrol II Transmitter & Dock. Now you can transmit your MP3 music from your MP3 Player or PDA to your car stereo.



Step 1

A Adjusting the Cradle

Pull the arms at the sides of the unit apart.

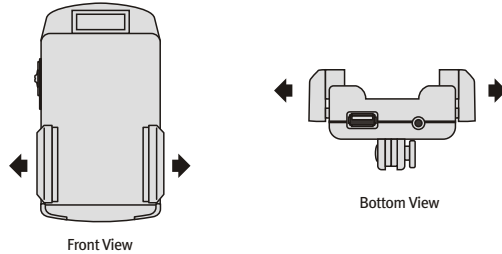

B Connecting to your MP3 Player

Attach the supplied 3.5mm connector to the **Headphone** socket of your MP3 Player or PDA, or attach the supplied 2.5mm connector to the headphone socket of your PDA.



For product support, check the latest instructions & updates in the Support Section of our website: www.cygnett.com or email us at info@cygnett.com

The use of this equipment by consumers is illegal in UK

This device complies with Part 15 of FCC Rules. Operation is subject to the following conditions:
(1) This device may not cause harmful interference, and
(2) This device must accept any interference that may cause undesired operation.

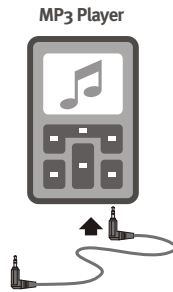

C Connecting to Groove Cruise

Place your MP3 Player / PDA between the arms and gently squeeze the arms together to hold snugly. Plug the other end of the connector into the 3.5mm jack at the bottom of the GroovePatrol II.

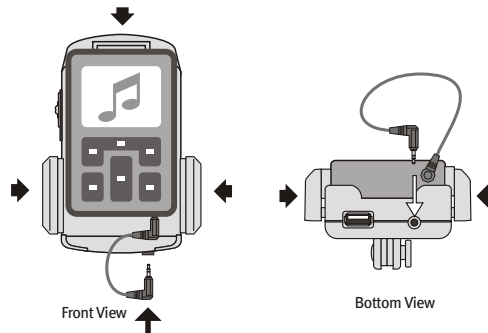

Step 2 Charging

Connect the cable to your MP3 Player / PDA via the USB socket under the GroovePatrol II to charge the unit.

Please find included a USB to USB mini cable, suitable for most MP3 Players. If your MP3 Player / PDA has a different connection then use the USB cable provided with your MP3 Player / PDA to connect to the computer.

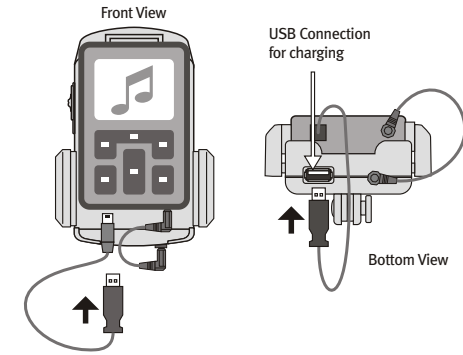

Please note that you may wish to adjust the settings on your MP3 Player / PDA so that the screen is always backlit for strongest and most stable FM Signal. Please refer to your unit's manual for notes on how to do this.

Step 3 Adjusting the Holding Angle

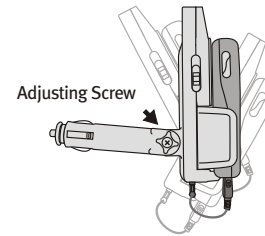

Loosen the adjusting screw and insert the arm into your car cigarette lighter. Push gently until it is fully inserted. Adjust it to the angle that suits you and the shape of your dashboard for easy access then tighten the screw in this position.

Step 4 Tuning your GrooveCruise II

Select a clear (unused) frequency on your FM radio and set the GroovePatrol II to transmit to that station.

Press play on your MP3 Player / PDA, ensuring that the volume of your car radio is turned to an audible level.



- If you are experiencing static or distortion, adjust the volume on your MP3 Player / PDA to achieve the best results.
- In different areas, reception may vary and you may wish to try out different frequencies to determine the best quality transmission.
- You may wish to adjust the settings on your MP3 Player / PDA so that the screen is always backlit for strongest and most stable FM signal. Please refer to your unit's manual for notes on how to do this.

